

SIMPLIFIED SCHEMATIC

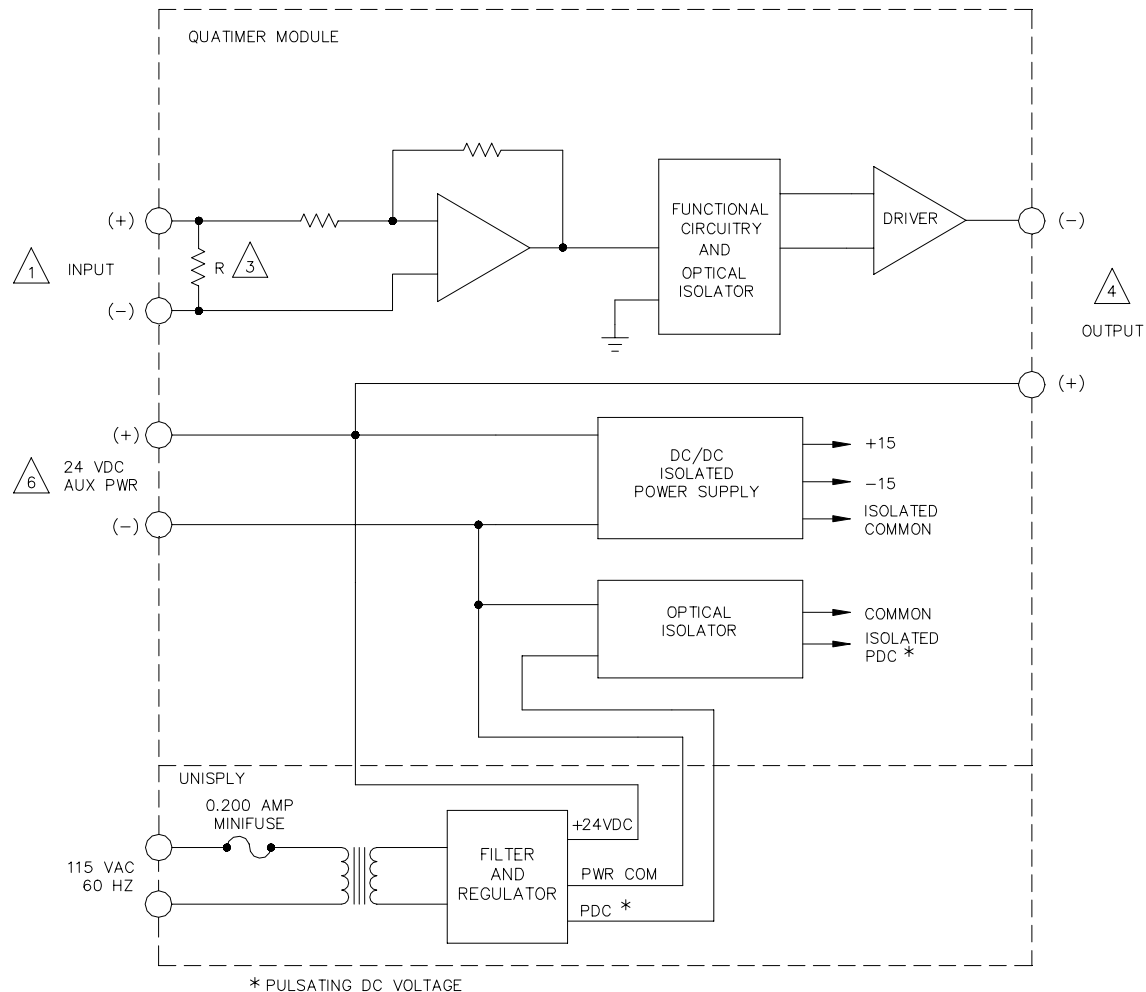

NOTES:

1. MODULES ARE TA5000 SERIES PLUG-IN. REFER TO SERIALIZED NAMEPLATE ON SIDE OF MODULE FOR INPUT/OUTPUT SPECIFICATIONS.
2. TERMINALS ARE #6-40 SCREW TYPE BARRIER STRIP.
3. THE VALUE OF "R" DEPENDS ON THE SPECIFIED INPUT SIGNAL. TYPICAL VALUES FOR "R" ARE:  
 $4/20\text{mA} = 50 \text{ OHMS}$ ,  $10/50\text{mA} = 20 \text{ OHMS}$   
 $1/5 \text{ VDC} = \text{EXCESS OF } 1 \text{ MEGOHMS}$
4. OUTPUT IS AN ISOLATED VOLTAGE PULSE AT 24 VDC 100mA MAXIMUM.
5. FOR LEAD LENGTHS MORE THAN 50 FEET TAKE PRECAUTIONS TO REFERENCE SIGNAL INPUT LEADS TO 115 VAC POWER GROUND.
6. 24 VDC AUX POWER OUTPUT POWER LIMITED TO 100mA. 24 VDC (+) & (-) IS ISOLATED FROM SIGNAL INPUT AND SIGNAL OUTPUT COMMONS.
7. EQUIPMENT MUST HAVE GOOD VENTILATION. AMBIENT TEMPERATURE NOT TO EXCEED 50° C.

OUTLINE DIMENSIONS IN INCHES.

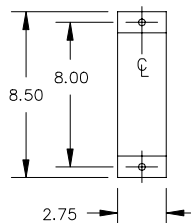

SIGNATURE	DATE	AGM ELECTRONICS, INC.			
DRAWN BY RC	9/2/76	TUCSON, ARIZONA			
CHECKED BY LMW	9/2/76	WIRING & SCHEMATIC DIAGRAM			
APPROVED BY JHL	9/2/76	QUANTIMER			
APPROVED FOR PROD.		2 WIRE INPUT, VOLTAGE PULSE OUT			
CONTRACT NO.		PTA MTG			
PCB 8187		CODE IDENT NO.	SIZE	PART NO.	REV
			A	WSD-C20236-16	A
		SCALE NONE	WT	SHEET 1 OF 1	